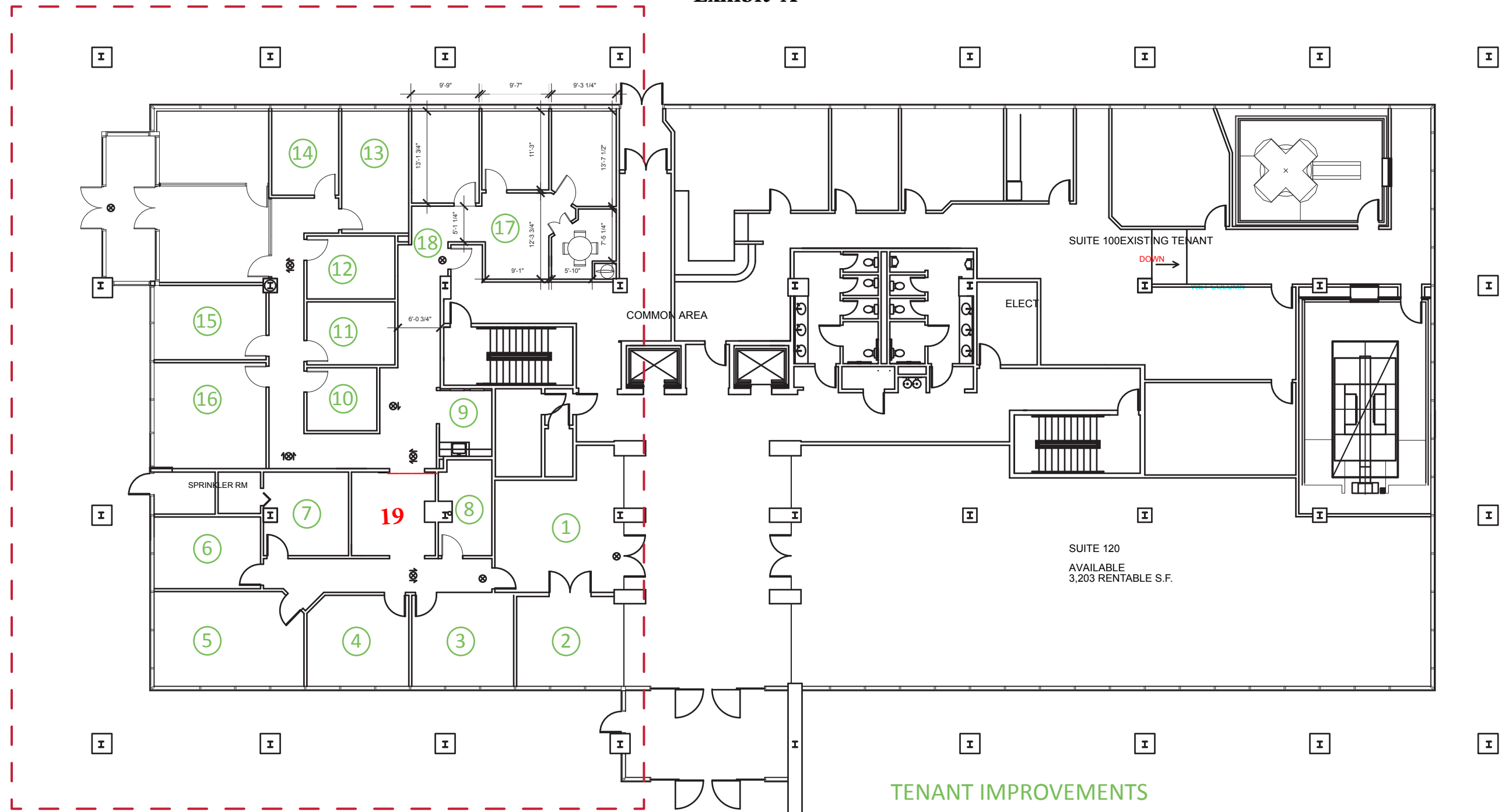

Exhibit 'A'



LCG new Premises as of April 2, 2018 is rooms 1-8 and 19.

TENANT IMPROVEMENTS

- * All common hallways to receive new paint
- * Rooms 1-9 to receive new paint and new carpet as specified by LCG
- * Rooms 10-16 to receive new carpet as specified by LCG
- * Expansion Area- 17: Tenant Improvement managed by UCH - Standard Finishes apply
- * Hallway Area connecting new Expansion Area- 18: Hard drop ceiling to be installed in this area.
- * New Offices will have 3' x 8' Solid Wood Doors installed.
- * New Conference Room doors will have glass inserts.
- * All damaged blinds will be replaced in both the new space and existing space.

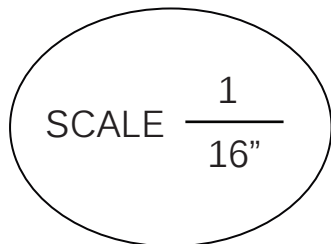

50 MONUMENT ROAD
BALA CYNWYD, PA 19004

LCG EXPANSION

FLOOR PLANS
EXISTING - IMPROVEMENT AREA